



# CLF-NA

## Compression Load Cell 3 ~10 MN



The CLF-NA Load Cell is a thin load cell with a flat load bearing surface. It is widely used as a load sensor for industrial machinery, especially when measuring loads on rolling machines or measuring compression force on presses.

Protection ratings : IP 65 equivalent

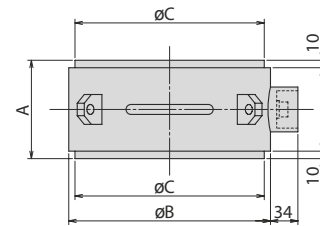
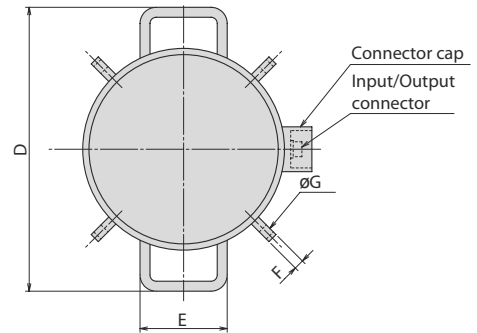

Force should be applied uniformly to the surface including guide circle.

### Specifications

Type	CLF-3MNA	CLF-5MNA	CLF-10MNA
Capacity	3MN	5MN	10MN
Rated Output	1.5mV/V (3000×10 <sup>-6</sup> strain) ±0.5%		
Non-linearity	0.3%RO		
Hysteresis	0.2%RO		
Temperature effect on zero	0.01%RO/°C		
Temperature effect on span	0.005%/°C		
Compensated temperature range	- 10 ~ + 60		
Temperature range	- 20 ~ + 70		
Over load	150%		
Input/output resistance	350Ω±5%		
Recommended exciting voltage	Less than 10V		
Allowable exciting voltage	20V		
Zero balance	5%RO		
Weight	40kg	66kg	150kg

Supplied cable : CT9-4N10/WP-STB (ø9mm 0.5mm<sup>2</sup> 4-core shielded chloroprene cable 10m)

### Dimensions

Type	A	B	C	D	E	F	G
CLF-3MNA	125	255	240	355	110	13	11
CLF-5MNA	135	320	300	430	120	16	13
CLF-10MNA	170	415	390	555	130	27	22

### ALTHERIS bv

Scheveningseweg 15  
 2517 KS DEN HAAG  
 The Netherlands

+31 (0)70 3924421

+31 (0)70 3644249

Offices in : Benelux | Germany | France | UK | Italy | USA

www.altheris.com

sales@altheris.nl

LEADERS IN SENSORS & HEAVY DUTY JOYSTICKS

**ALTHERIS**  
 SENSORS & CONTROLS