

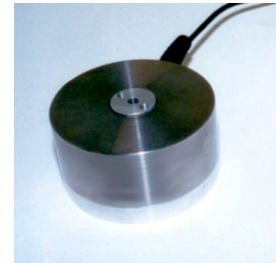

## FLF310 Axial Force and Torque Transducer Range $\pm 50\text{N}$ and $2\text{Nm}$

- Low cross talk
- Custom ranges
- Simple installation
- Direct outputs without calculation
- Standard 2 year warranty



**ALTHEN**  
MESS- UND SENSORTECHNIK

Geometry: Monocoque strain structure with no moving parts.

The FLF310 depicted measures force and torque in the same axis with minimal cross talk providing user friendly outputs for direct measurement without mathematical manipulation.

Each channel may be calibrated bi-directionally. The version of the transducer depicted was developed for an OEM producing texture analyser machines (rheometers) for use in the food process industry.

We are happy to design variants of this loadcell to meet your specific requirements. Variants may include different combinations of force and moment axis e.g.  $F_x M_z$ ,  $F_y M_x$ ,  $F_z M_y$  etc.

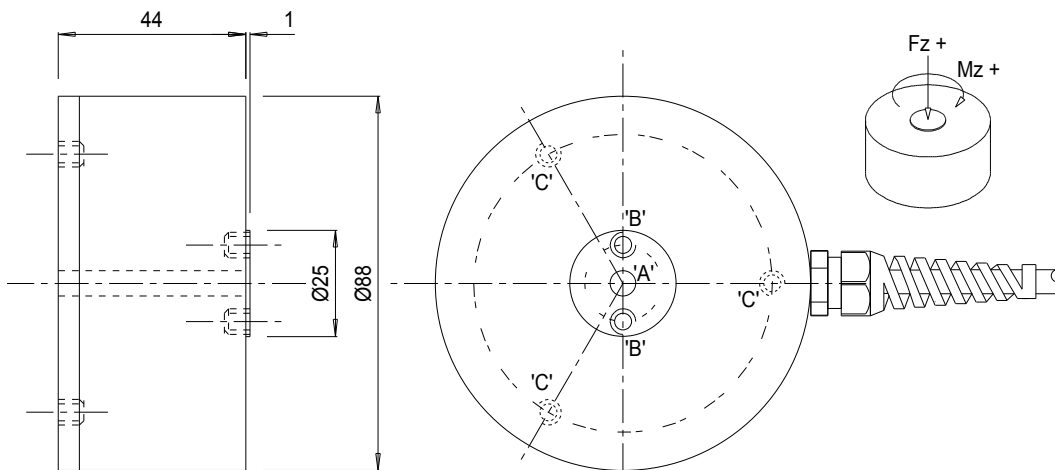

'A' Ø6 THRO. 'B' M6x1 ON A 18 PCD - 2 OFF. 'C' M6x1 EQUI SPACED ON A 70 PCD - 3 OFF

## ■ Specifications

Parameter	Value	Unit
Non-linearity - Terminal	±0.05	% RL
Hysteresis	±0.05	% RL
Creep - 5 minutes	±0.1	% AL
Repeatability	±0.05	% RL
Maximum cross talk	1	% RL
Rated output - Nominal	0.6	mV/V
Rated output - Rationalised	0.5	mV/V
Rationalising tolerance	±0.5	% RL
Zero load output	±4	% RL
Temperature effect on rated output per °C	±0.005	% AL
Temperature effect on zero load output per °C	±0.02	% RL
Temperature range - Compensated	-10 to +50	°C
Temperature range - Safe	-10 to +80	°C
Excitation voltage - Recommended	10	V
Excitation voltage - Maximum	10	V
Bridge resistance	350	Ω
Insulation resistance - Minimum at 50Vdc	500	MΩ
Overload - Safe	50	% RL
Overload - Ultimate	300	% RL
Sealing	IP65	
Weight - Nominal (excluding cable)	250	g

The standard range is manufactured in aluminium.

## ■ Notes

1. AL = Applied load.
2. RL = Rated load.
3. Temperature coefficients apply over the compensated range.
4. Values apply to force and moment in all load combinations.

## ■ Connections

The FLF310 is fitted with 2 metres of PVC insulated 9 core screened cable type 7-1-9C. The screen is not connected to the loadcell body.

Function	Wire Colour	
	Fz	Mz
Excitation +	Red	Violet
Excitation -	Blue	Black
Signal +	Yellow	Brown
Signal -	Green	White
Screen	Orange	

## ■ Ordering codes

See the ordering code sheet for more details. Add ranges in the required units.
Most FLF310 transducers are manufactured to special requirements and are given an FLF310-Zxxxx number.

## ALTHERIS bv

Scheveningseweg 15  
2517 KS DEN HAAG  
The Netherlands

+31 (0)70 3924421

+31 (0)70 3644249

Offices in : Benelux | Germany | France | UK | Italy | USA

www.altheris.com

sales@altheris.nl

LEADERS IN SENSORS & HEAVY DUTY JOYSTICKS

**ALTHERIS**  
SENSORS & CONTROLS